

FRAME SECTION VIEW  
SCALE 1:4

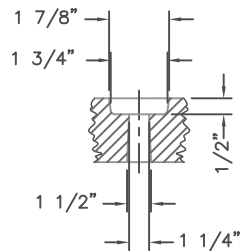

TYPICAL BOLT SLOT DETAIL  
SCALE 1:4

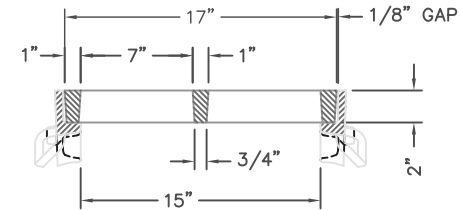

R-4990-EA BOLTED  
TYPE "A" GRATE AND TYPE "B" FRAME  
TYPICAL SECTION

NOTE: MEETS MINIMUM 100,000 LOAD REQUIREMENTS PER FAA AC150/5320-60 APPENDIX 3.2.d.1. (ACTUAL PROOF LOAD IS OVER 200,000-POUND ON A 9" X 9" CONTACT AREA.)  
 COMP. NO'S: SIDE FRAME 4999-2400, END FRAME 4990-3117, GRATE 4999-0017  
 MATERIAL: GRATES - CAST DUCTILE IRON ASTM A536, 55 + KSI YIELD  
 FRAMES - CAST GRAY IRON ASTM A48, CLASS 35B  
 FINISH: NO PAINT

DR. E. NIVER	SCALE 1/8"=1"	TITLE: R-4990-EA DOUBLE BOLT STYLE TYPE "A" GRATE w/ TYPE "B" FRAME
CH.	DIM CHK.	NEENAH FOUNDRY COMPANY
APP.		NEENAH FOUNDRY COMPANY
DATE 03-12-2012		NEENAH WISCONSIN 54956