

**NEW**

**R-3587-4**  
**4-Flange Gutter Inlet Frame, Double Grate**

Heavy Duty

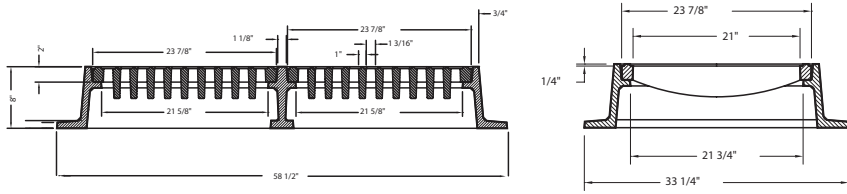

| CATALOG NUMBER | GRATE TYPE | SQ. FT. OPEN | WEIR PERIMETER LINEAL FEET |
|----------------|------------|--------------|----------------------------|
| R-3587-4       | D          | 3.5          | 12.0                       |

**R-3588**  
**4-Flange Gutter Inlet Frame, Grate**

Heavy Duty

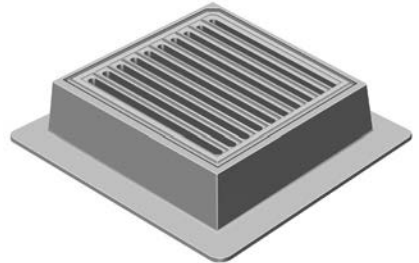
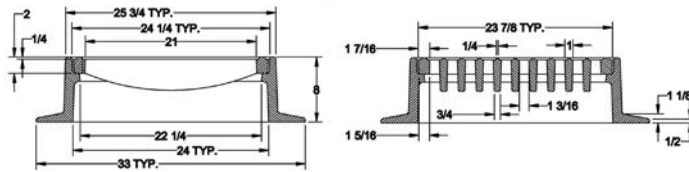

| CATALOG NUMBER | GRATE TYPE | SQ. FT. OPEN | WEIR PERIMETER LINEAL FEET |
|----------------|------------|--------------|----------------------------|
| R-3588         | D          | 1.8          | 7.9                        |

**R-3588-A**  
**4-Flange Gutter Inlet Frame, Grate**

Heavy Duty

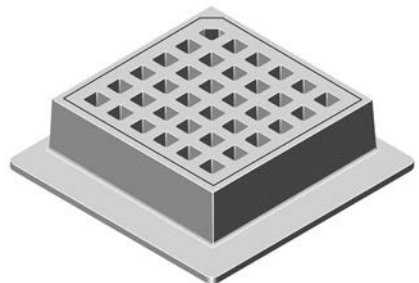
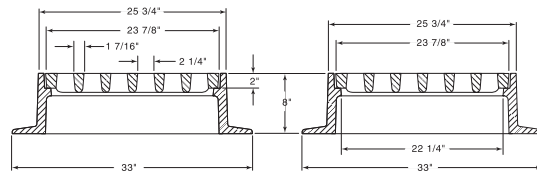

| CATALOG NUMBER | GRATE TYPE | SQ. FT. OPEN | WEIR PERIMETER LINEAL FEET |
|----------------|------------|--------------|----------------------------|
| R-3588-A       | H          | 1.2          | 7.9                        |

**R-3588-LL**  
**4-Flange Gutter Inlet Frame, Grate**

Heavy Duty

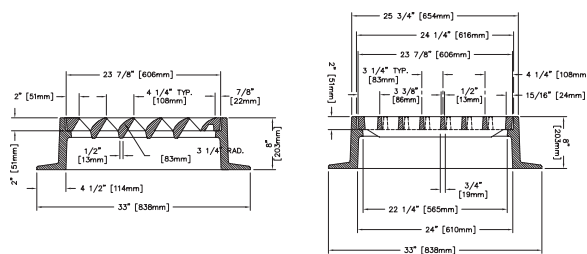

| CATALOG NUMBER | GRATE TYPE | SQ. FT. OPEN | WEIR PERIMETER LINEAL FEET |
|----------------|------------|--------------|----------------------------|
| R-3588-LL      | L          | 1.6          | 7.9                        |
| R-3588-LR      | L          | 1.6          | 7.9                        |

Unit illustrated is for flow to the left. If flow to the right is required, order **R-3588-LR**.

ROLL & GUTTER INLETS  
5