

<p><b>Number</b> <b>LZ1000 End Caps</b></p>	<p><b>Series</b> <b>CPS554</b> 4" Wide Shallow End Caps LZ1000 Series 3.1 Inch Depth</p>
---	--

**155577**

**80MM - 3.1 Inch Depth for Channel Start**

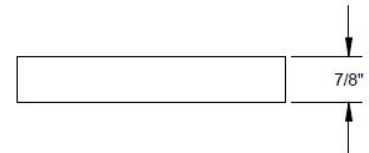
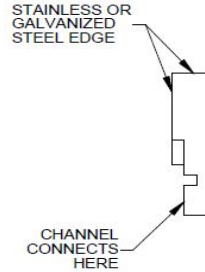
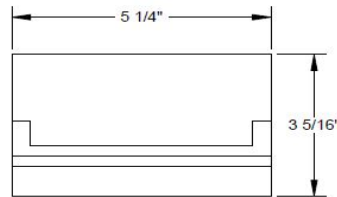
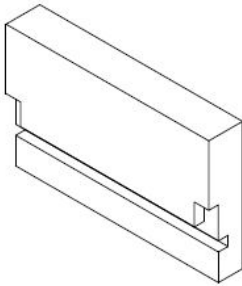

**155579**

**80MM - 3.1 Inch Depth For Channel End**

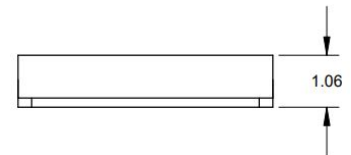
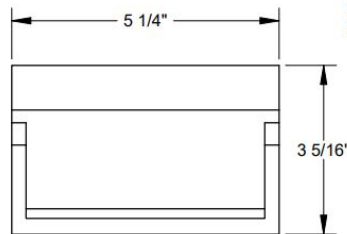
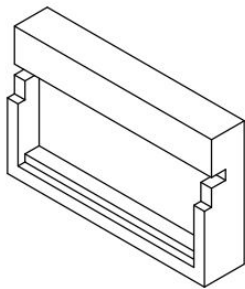

**155581**

**80MM - 3.1 Inch Depth 2" Outlet Endcap**

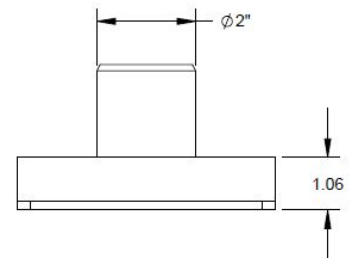
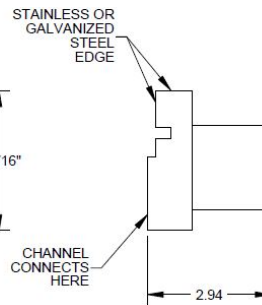
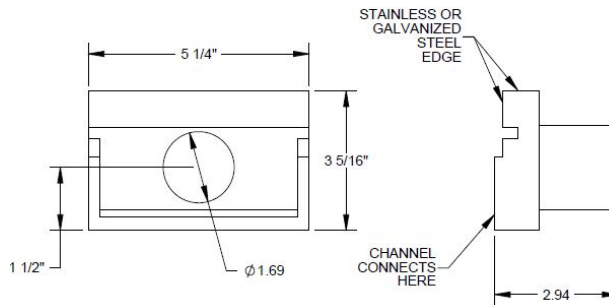
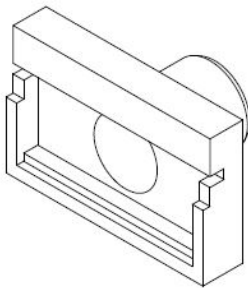

<p><b>Manufacturer</b></p>  <p>Quality engineered trench drain system</p>	<p><b>Specification</b></p> <p>MEA-JOSAM LZ1000 SERIES TRENCH DRAIN EEND CAP SET CONSTRUCTED OF POLYMER CONCRETE WITH GALVANIZED STEEL PROTECTED EDGES. MEETS LOAD CLASS A, B, AND C. SUPPLIED BY TRENCH DRAIN SUPPLY.</p>
--	--

DISCLAIMER - The customer and the customer's architects, engineers, consultants, and other professionals are completely responsible for the selection installation and maintenance of any product purchased from Trench Drain Supply and/or its manufacturers. TRENCH DRAIN SUPPLY MAKES NO WARRANTY, EXPRESS OR IMPLIED, AS TO THE SUITABILITY, DESIGN, MERCHANTABILITY, OR FITNESS OF THE PRODUCT FOR CUSTOMERS APPLICATION. The drawing and information provided remain the property and copyright of the manufacturer listed. The manufacturer reserves the right to modify specification without notice.