

(2x) slot for M8 button head screw, locations correspond w/bolt-dn holes in MEADRAIN™ channel

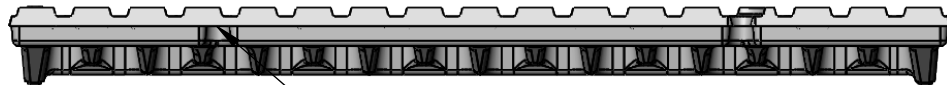

(2X) drill point to locate hole

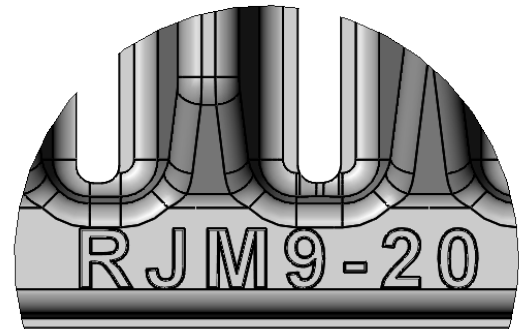

Supplied By:  
**TRENCHDRAIN SUPPLY**  
 877-903-7246  
 www.trenchdrainsupply.com

**NOTES:**

1. Heel Proof: No openings greater than 6mm.
2. Ships in 1 piece.
3. Due to casting inconsistencies, all dimensions are nominal.

**Regular Joe 9" Trench Grate Heelproof**

Made in USA ©2018 Iron Age Designs

**IRON AGE DESIGNS**  
 Telephone 206.276.0925  
 www.ironagegrates.com

Material: Cast Ductile Iron

Weight: 12.97kg [28.53lbs]

Free Area 14838.03sq/mm (23.15sq/in) By: MS Date: 7-5-18 (approx): (13.36%)

Standard Finish: Natural

Thickness Edge: 20mm [.7874"]

Gallon/ Min 30.33 gl/min. (approx):

Job No: XXXXXXXX Scale: 1:4

© Registration: XX-1-XXX-123

Fits: MEADRAIN™ D400/E600 trench drains Product ID: RJM9-20

Drawing Name: 02-Joe.M.9x20\_hp\_E600