

14.093"

2.813"

IRON AGE

TOP VIEW
scale 1:2

0.361" top thickness max.

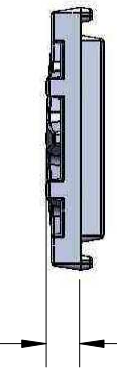

END VIEW
scale 1:2



FRONT VIEW
scale 1:2

(2X) divots to locate bolt down holes

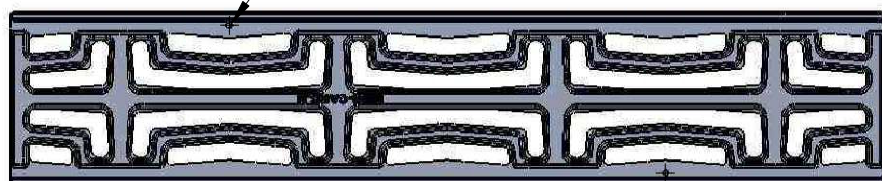

BOTTOM VIEW
scale 1:3

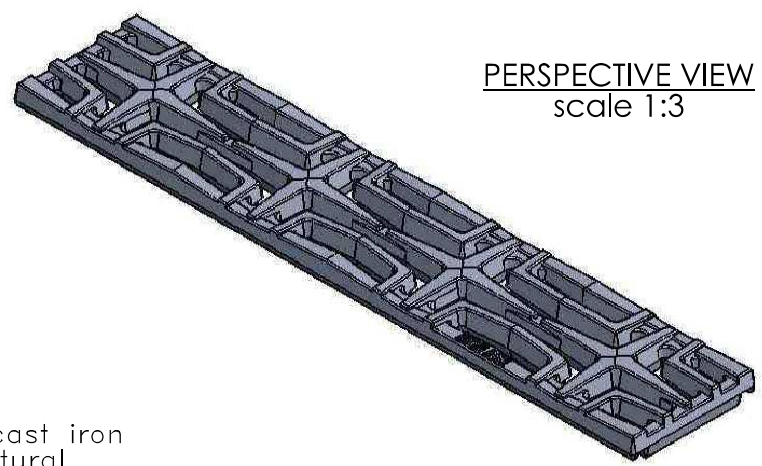

PERSPECTIVE VIEW
scale 1:3



2104 SW 152nd St. #4 TEL 206.276.0925
Burién, WA 98166 FAX 206.257.0318
www.ironagedrains.com

NOTES:

1. Material: cast iron
2. Finish: Natural
3. Edge Thickness: approx. 9/32"
4. Replaces drain manufactured by: NDS® Mini-Channel
5. No openings great than: 3/8"
6. Due to casting inconsistencies all dimensions are nominal

Carbochon 3"x14" Trench Grate

Drawn by: CD

Date: 04/5/08

Scale: NTS

DWG. NO. CAR.N.03x14

© 2008 Iron Age Designs Registration Number: VA 1-970-774